

Introducing the Artists

Exhibition Information



Please scan to access our feedback form

This year we are celebrating 10 years of The Suttie Arts Space, which opened with its first exhibition 'Same Same But Different' in November 2014.

For our first exhibition of 2024, we have brought together artwork by Grampian Hospitals Art Trust (GHAT) staff, who are also creative practitioners in their own right. This is a celebration of the artists who organise and deliver various projects across NHS Grampian (NHSG) sites, including Artroom, Art Collection and Projects.

This is an opportunity to promote the artists who are the driving force behind Grampian Hospitals Art Trust and highlight the range of practices within the GHAT team. Due to the nature of some of the team's jobs, it is not always obvious to people who work with them on a daily basis that they have their distinct practices. The work on display will include writing, sculpture, painting, ceramics, textiles and film.

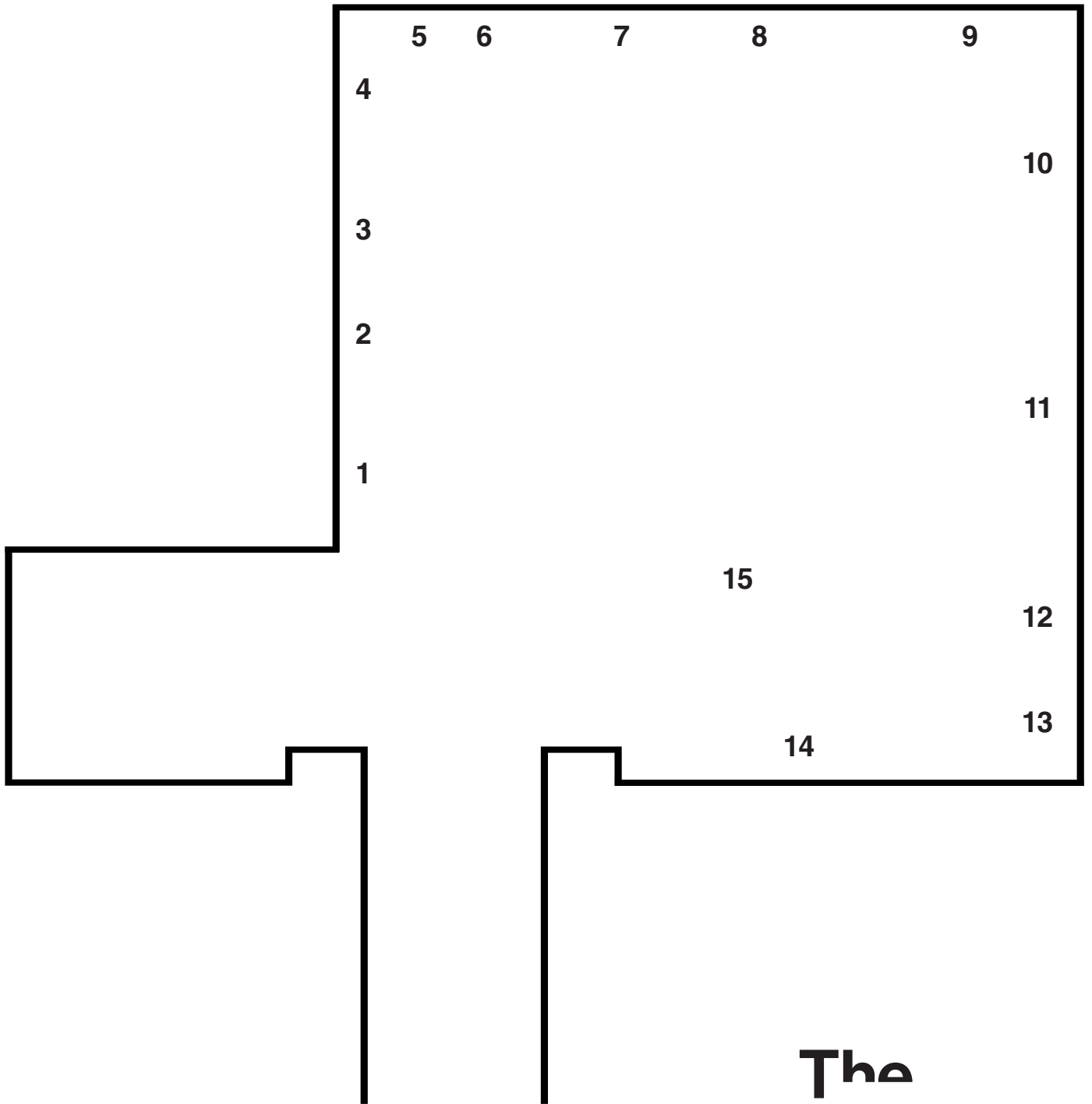

The Suttie Arts Space

Grampian Hospitals
Art Trust

| | | |
|---|---|---|
| 1 | Ceramics by Sally Thomson | Artist information Page 6 |
| 2 | Untitled Neal MacDonald Mixed Media on canvas | Artist information Page 6 |
| 3 | Untitled Neal MacDonald Mixed Media on canvas | |
| 4 | A Dark Snowy Night Elaine Grant Mixed media | Artist information Page 6 |
| 5 | The Checkout Operator Alexandra McGregor Digitised found 35mm film by 'The Industrial Society' | Artist information |
| 6 | She Is Systematic Alexandra McGregor Printmaking, sculpture and textiles | Page 7 |
| 7 | Februllage Donna Briggs Analogue collage | Artist information Page 8 |
| 8 | The Heart Of Discovery Emily Utter (collaboration with Katie Guthrie) Digital print on board | Artist information and full poem Page 8 |
| 9 | In The Deskry (May 2023) Phoebe Banks Film | Artist information Page 10 |

| | | |
|-----------|---|--|
| 10 | Sunrise Spectrum Rebecca Paterson Mixed media on hardboard | Artist information Page 10 |
| 11 | Coming Home Laura Mullen Oil on canvas | Artist information Page 11 |
| 12 | Collape! Jenny Hood Digital collage | Artist information Page 11 |
| 13 | It Continues Jean Firth Mixed media on copper | Artist information Page 12 |
| 14 | Waves Jo Gilbert Vinyl text on window | Artist information and original text Page 12 |
| 15 | Untitled Anna Shiirron Hand cut paper | Artist information Page 13 |

Sally Thomson

GHAT Director

As I embarked on my artistic career in the dim and distance past it was to study ceramics. However, after my first year of art school I migrated to fine art with a strong hint of the maker woven into my practice, predominantly involving textiles, feltmaking and pattern.

The maker in me has never receded and during the pandemic I was given a kiln which encouraged me to return to ceramics after a 35-year break. These works are my experimentations with throwing, glazes, and surface printing.'

Neal MacDonald

Senior Creative Practitioner - Artroom

Neal MacDonald takes inspiration from elements of chance, found objects, google algorithms, and aims to elevate the everyday.

Neal won the Aberdeen Artists Society Second Prize in 2022 with his oil painting 'An Artists Impression of a Flemish Aristocrat's Skull found in a Supermarket Carpark'.

Elaine Grant

Creative Practitioner - Artroom

Elaine Grant is a textile artist, designer and maker based in Aberdeen. Her creative practice engages with concepts of childhood and nostalgia. Often influenced by her own childhood memories, her experiences as a mother and stories from those around her.

With a focus on her love of colour, pattern and a passion for craft and making, Elaine combines the beautiful naivety and wonder of childhood to create colourful

characters, soft sculptures, playful accessories, and decorative homewares. Working on one-off designs, limited edition collections and bespoke commissions she aims to bring feelings of joy and endearment to all through her work.

Engagement and participation are integral to Elaine's practice. Embracing opportunities to share her skills, inspire others and be inspired, she facilitates private and commissioned workshops with local charities, organisations and schools within Aberdeen as well as delivering Artroom sessions with GHAT across hospital and community settings.

Alexandra McGregor

Project Assistant

Alexandra McGregor is a Performance and Visual Artist based in Aberdeen, who graduated from Gray's School of Art with a BA(Hons) in Contemporary Art Practice.

Performance, print, and drawing are primary processes used to investigate the feminine. Her work interweaves elements of folkloric and historic material to explore the past, present and future place, and role of women. The narratives in Alexandra's practice take inspiration from past residue, re-examining and reforming feminine rites and traditions that seek to uncover the contemporary female.

The artwork 'She is Systematic' on display was partly created for The Royal Scottish Academy New Contemporaries Exhibition in 2018, where Alexandra performed, creating printed fabric strips using a large handmade stamp, both items can be seen in the display cabinet. This work was inspired by a found film reel called 'The Checkout Operator', that you can see displayed on a TV. This instructional film probably dates from the 1960's and was part of a sales training series created by The Industrial Society organisation. The film instructs on how to be an effective checkout operator and consists of information probably considered outdated nowadays. The film provides interesting glimpses of this past industry and workforce.

Donna E Briggs

Creative Practitioner - Artroom

Donna E Briggs studied printmaking at Gray's School of Art and graduated from Robert Gordon University with a BA (Hons) in fine Art – Printmaking. Since then, she has exhibited artwork in open exhibitions and solo shows and has completed commissioned work for businesses in Aberdeen City.

Donna won a Purchase Prize in 2008 and was later commissioned by Grampian Hospitals Art Trust to make site-specific work for a reminiscence room in Aberdeen's Royal Cornhill Hospital. Since 2008, Donna has been working as an Artist for the Artroom project at Roxburghe House. Donna is currently based out of Newtonhill, just south of Aberdeen. Her practice is multi-disciplinary and focuses mainly on the embedded emotions and memories in found and rediscovered objects and photographs.

Emily Utter

Senior Creative Practitioner - Artroom

Emily Utter is a Canadian writer who lives in Aberdeen. Her short stories and creative non-fiction have been widely published in magazines and journals, including Gutter, Northwest Review, Geist, and the best of Canadian flash fiction anthology, This Will Only Take a Minute.

Emily has a PhD in Creative Writing from the University of Aberdeen and is the Writer-in-Residence at Aberdeen's specialist palliative care hospital, Roxburghe House. It is this work that has inspired her novel-in-progress, The Night Room, which was shortlisted for the Discoveries Prize in 2023.

She regularly facilitates private and commissioned workshops with local charities and organisations in Aberdeen and has taught creative writing at both North East Scotland College and the University of Aberdeen.

“The Heart of Discovery” was composed by Emily for University of Aberdeen Science Teaching Hub, and produced in collaboration with artist, Katie Guthrie.

You can read the original poem below:

**The heart of discovery:
a resolution to move, to
matter, to transform.**

Find structure

then

change

**from one
composition to**

another.

Wear but not waver,

drift

apart,

**rise,
and recreate
the world around us.**

**If we are stardust,
we are sand.**

We are

bond

breaking,

reforming, and

the land in your bones.

Phoebe Banks

Gallery Assistant

Phoebe Banks is an Aberdeen based artist whose work intersects writing, sculpture and video. She enjoys playing with functionality and creating works as tools for a specific purpose. Video is used to activate a sculpture or piece of writing, exploring simplistic ideas to an exaggerated degree.

Ultimately Phoebe's practice is something that brings her joy by giving space and significance to otherwise fleeting thoughts or concepts. Phoebe works within artists collective Tactics for Togetherness and creative duo CUSP, a collaboration with artist and friend Jess Wilson-Leigh.

'In the Deskry (May 2023)' was made whilst Phoebe was in residence at Clashnettie Arts Centre, Strathdon. Created with a desire to play with scale, these sculptures are carved from blocks of recycled industrial polystyrene and were originally intended to be comically oversized teeth. Within the Aberdeenshire landscape they seem more obscure. Alien and animal-like, they sit quiet and still within the flowing water of the burn.

Rebecca Patterson

Creative Practitioner - Artroom

After graduating from Gray's School of Art in 2009 with a BA(Hons) in Painting and again in 2010 with a Masters of Fine Art, Rebecca has been fortunate to have had over a decade to develop her practice.

'My work is a frenzy of material and processes, a direct representation of my mind and how I create. Heavily inspired by the natural landscape of the North East of Scotland my work borders into the abstract and explores fleeting moments and feelings. Growing up on the Moray coast I have a subconscious pull towards the land and sea as well as the flora of the area, tied up in memories of walks and times exploring. Living in a city now has me dreaming

of wilderness, making me appreciate any time I can venture out and collect moments of raw natural energy and beauty. This all filters through into my practice, a desire to create and to remember those feelings and experiences, they are completely symbiotic.

I believe there is a real familiarity in my work, viewers too can feel the essence and the intimacy even if they have never been acquainted with this part of the world. I work organically and rhythmically in layers of mixed media. Pieces tell me what they want to be rather than me coming at them with preconceived ideas and plans, they materialise out of the ether and guide me to completion.'

Laura Mullen

Creative Practitioner - Artroom

Laura Mullen is a Scottish artist based in Aberdeenshire who graduated from Gray's School of Art in 2014.

Her work draws from themes of memory, storytelling, and a sense of place. Her recent paintings are particularly shaped by nature, seeking to encapsulate the immersive and sensory experience of being in natural surroundings, emphasizing the connection between people and their environment.

Laura's painting 'Coming Home' selected for the exhibition was featured as part of Aberdeen Artists society online show with Aberdeen Art Gallery and Museums in 2020.

Jenny Hood

Creative Practitioner - Artroom

Jenny graduated from Gray's School of Art in 2009 and has since practiced as a freelance artist exhibiting nationally and internationally. Working primarily in photography and digital collage, her work undertakes explorations of a range of preoccupations, including the construction of the self, both online and off, the

tensions in our relationships with the non-human world, and seeking often missed details of the every day.

Under her 'Corvid Eyes' remit she has completed site-specific outdoor and indoor collaged 'paste ups' across Scotland. As a working moniker, 'Corvid Eyes' describes a 'magpie' method of working- collecting a miscellany of imagery from a variety of historical and contemporary sources, to be reassembled into new narratives of sorrow, joy, and the absurd.

Jean Firth

Collection Assistant

Jean Firth is an artist based in Aberdeen. Through a process of drawing, collage, and construction through layers of material, Jean plays with the form of the woodlouse - itself made from segmented layers of exoskeleton. During the process of building and then disguising the forms, Jean aims to explore the nature of the overlooked isopods through her practice.

Jo Gilbert

Senior Manager - Artroom

Jo Gilbert is a spoken word artist and writer from Aberdeen. Their work has featured on BBC Radio 4 show Tongue and Talk, in art exhibitions and films and spray-painted on a mural at Aberdeen Beach. Past projects and commissions include StAnza Poetry Festival, Aberdeen Art Gallery and Museums, National Theatre of Scotland, and Aberdeen Performing Arts.

Jo's poem 'Yon Hairy Stick' was selected as one of the Scottish Poetry Library's Best Scottish Poems in 2022. Their debut poetry collection 'WTF is normal anyway?' published in August 2022 with Seahorse Publications was nominated for a Scots Language award in 2023.

You can read the original work on the next page:

'Waves' by Jo Gilbert

The sea is bottle-green and silver-grey mud all at once you play out over the radio Candi Staton singing in the ghetto and I know it's you laughing at the time you met her invited her to yours for a plate of mince and tatties and I know you'd have loved them Candi like I loved her like the taste of comfort and home.

Anna Shirron

Senior Creative Practitioner - Artroom

Anna Shirron is a Visual Artist working mainly within the fields of paper cutting and painting. In 2007 Anna graduated from Grays School of Art with a degree in Painting and went on to complete a Master of Fine Art in 2010. In 2017 GHAT commissioned Anna to work in collaboration with artist Rachel Barron to create a site-specific installation for The Suttie Arts Space, which took the hospital's interior as its starting point, exploring architectural elements typically go unnoticed.

'My work concerns itself with pattern and detail, looking at the idea of 'beauty' and 'ugly' – using materials, patterns and motifs that may normally be considered purely decorative to depict more challenging subject matters.

I have run paper cutting and painting workshops at various venues over the last 17 years. In addition to this I have recently taught at the University of Aberdeen and since 2007 I have also led various art sessions in a community and hospital context.'

gram.hospitalsarttrust@nhs.scot
www.ghat-art.org.uk

 @GHATArt

 Grampian Hospitals Art Trust

 grampian_hospitals_art-trust

Grampian Hospitals Art Trust
The Art Office
Aberdeen Royal Infirmary
Foresterhill AB25 2ZN
01224 551776
