

**The  
Suttie Arts  
Space**

Grampian Hospitals  
Art Trust

# **Abstracted Landscapes**

**9.2.23 - 3.3.24**

The artwork in this exhibition was chosen by NHS Grampian and Grampian Hospitals Art Trust (GHAT) staff and visitors to The Suttie Arts Space from the GHAT Art Collection. The observations made while selecting the work reflect how they feel about their local environment, and range from personal memories to colours, subject matter, and sustainability.

GHAT invited NHS Grampian Sustainability Champions, alongside visitors to The Suttie Arts Space during a drop-in session, to select work from the GHAT Collection to display in this exhibition. We then asked everyone to write something about the work they selected.

Sustainability Champions are volunteers across all areas of NHS Grampian who work to embed sustainability in their area of work. They are a vital part of the organisation, as they act to highlight areas where improvement can be made in its sustainability and deliver sustainability actions and projects.

Website:

<https://www.nhsgrampian.org/about-us/planforthefuture/what-we-intend-to-do/places/environment/sustainability-champions/>

Facebook:

<https://www.facebook.com/NHSGSustainability>

The GHAT Art Collection is made up of artworks either commissioned or purchased over the past 40 years. Artwork is on display across over 40 NHS Grampian venues. This service is key to our original focus and fundamental to our relationship with people and places. The Art Collection store is located in ARI, and NHSG staff are invited to view artwork which creates a dialogue around its use and display. By involving NHSG staff in the curatorial process, we've had the positive result of communicating the Art Collection as a valuable cultural asset and offering insight behind the scenes of the work we do.

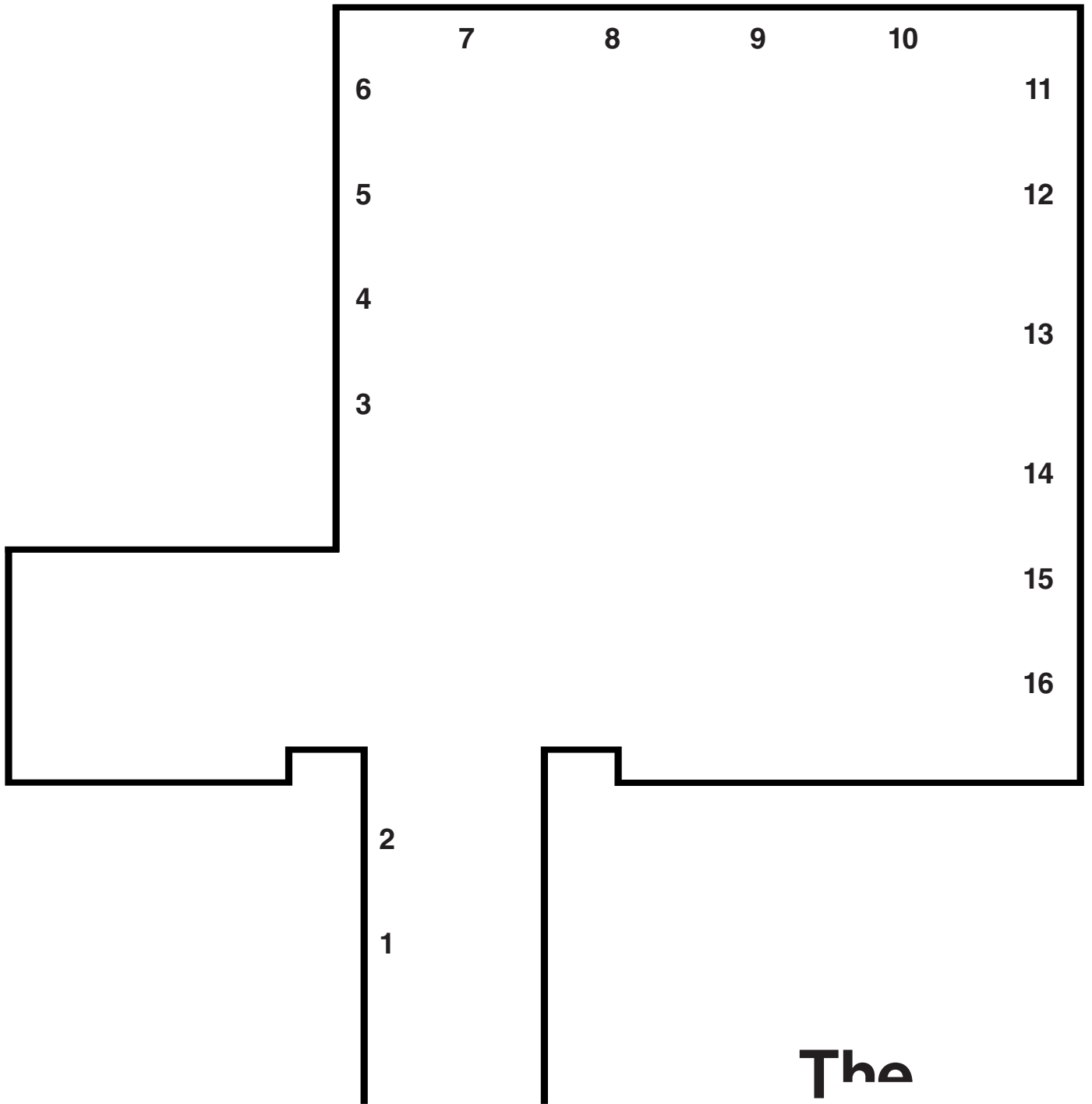

# The Suttie Arts Space

Grampian Hospitals  
Art Trust

**1 We Fall into Patterns Quickly (Axonometric Version)**

Toby Paterson

Screenprint

**2 Normandy Sketches**

Doug Prosser

Ink on paper

**3 Bird Song**

Neal Macdonald

Embossed print

**4 Yellow Buoys**

Sophie Macpherson

Oil on canvas

Chosen by Gemma (NHS Grampian Nurse)

Why I chose this artwork?

*'Vibrant Colours and interesting brush techniques'*

**5 Subject Box 1**

Ruth Beardsworth

Mixed media

Chosen by Alexandra McGregor (GHAT Project Assistant)

Why I chose this artwork?

*'I enjoy the way the natural materials have been used to create a nest form. The simplicity of the sculpture appeals to me, it reminds me of the joy of foraging and collecting natural materials from the woods to create collage works and reminds me of the amazing natural structures in our natural environment.'*

**6 Chequerboard**

Harvey Daniels

Woodcut print

**7 Botanic Gardens II**

Thomas Cameron

Oil on canvas

Chosen by Gemma (NHS Grampian Nurse)

Why I chose this artwork?

*'I love the colours and depth of forest/ jungle look.'*

**8 Grass Beneath the Trees**

Michael Porter

Oil paint and PVA on paper

Chosen by Rachel Roberts (NHS Grampian Environmental Manager)

Why I chose this artwork?

*'The initial chaos of this piece is what first allured me. I am reminded of a diverse assemblage of algae, lichens, and mosses, perhaps growing on an undisturbed tree branch in a humid Scottish landscape. The complexity of natural processes that take place all around us each day is both staggering and delicate.'*

**9 Untitled**

Donna Briggs

Digital print

**10 Astilbe**  
Bob Batchelor  
Screenprint

**11 Other Planets**  
Rob Ryan  
Screenprint

Chosen by visitor to The Suttie Arts Space

Why I chose this artwork?

*'I like the bright colour in the print & that it catches your eye.'*

**12 Rain at Dogshillock Farm or Harvest Time Hustle**  
G Shepherd  
Screenprint

Chosen by Jean Firth (GHAT Collection Assistant)

Why I chose this artwork?

*'I love this print for its bold use of colour and pattern – creating a thoughtful scene out of abstracted elements like the shear border, the checkered corners, and the mysterious eye observing the darkness. The bright green raindrops make me think of acid – and acid rain is a phenomena we have largely reduced in Europe and the Americas due to strong air pollution regulations. It's a hopeful reminder of the change humans are capable of, and the efforts needed to keep the planet alive.'*

**13 Untitled**  
Claire Roberts  
Screenprint

Chosen by Neil Duncan (NHSG Waste Management Officer and

Sustainability Champion)

Why I chose this artwork?

*'This picture reminds me of the mobius loop symbol used to denote recycling. Those images along with the images like flowers are nature - and they are represented as being in our hands to protect.'*

Why I became a Sustainability Champion?

*'It's important to work together as NHSG to improve recycling and reduce waste. It's my role to assist and advise staff wherever possible so they have the best options for their waste.'*

14

### **New RACH 12**

James Furneaux

Pen and ink on paper

Chosen by Craig Marr (Community Pharmacy Sustainability Champion)

Why I chose this artwork?

*'I chose this striking painting because of the greenspace area in front of the Royal Children's Hospital. Did you know that hospital patients with a view of trees from their window have been shown to recover more quickly and require fewer painkillers than similar patients who can't see trees from their beds? I can just imagine myself as a young boy, scared of hospitals, feeling a much-needed wave of calmness when looking out the window and seeing the beauty of nature. This painting looks like it was created in the winter months when trees were sparse; however, I can still picture the trees with birds nesting, singing, and feeding on berries.'*

Why I became a Sustainability Champion?

*'NHS Grampian will ensure that it Increases the amount of quality green spaces within our estate and promote the restoration of areas*

*deficient in ecological quality through habitat creation as well as changes to landscape management.'*

**15 Bridge Under Snow**

Peter Barton

Oil on laminate

Chosen by Martin Shapev (NHSG Dental Nurse Registrar)

Why I chose this artwork?

*'Very interesting abstract piece with initial impression of an unfolding waterfall over cliffs but the more you look the more interpret mountains in the distance with flow of water in the middle. I like the depth of expression and interpretation.'*

**16 In Mart, Aberdeen**

Nicki McHarg

Mezzotint print

Chosen by Kirstie Hendrie (NHSG Dental Nurse and Sustainability Champion)

Why I chose this artwork?

*'I really like how the artist has managed to get texture into this work and I love this piece. It also reminds me of going to Aberdeen Mart as a child.'*

Why I became a Sustainability Champion?

*'To try and improve the Dental department and to make changes to improve it's sustainability for NHSG'*







Please  
scan to  
access our  
feedback  
form

---

[gram.hospitalsarttrust@nhs.scot](mailto:gram.hospitalsarttrust@nhs.scot)  
[www.ghat-art.org.uk](http://www.ghat-art.org.uk)

 @GHATArt

 Grampian Hospitals Art Trust

 [grampian\\_hospitals\\_art-trust](https://www.instagram.com/grampian_hospitals_art-trust)

Grampian Hospitals Art Trust  
The Art Office  
Aberdeen Royal Infirmary  
Foresterhill AB25 2ZN  
01224 551776

---